



by  ERICH JAEGER

## 7P/12V 100% Watertight WEATHERLOCK™ Connectors - SAE J560 - with FIBERCORE™

It is our business to find optimum and safe solutions for various needs in the area of connectors and wires. For the truck and trailer connector market (SAE J560) and also for agricultural technology, we have an all-new solution with outstanding features for our customers. In comparison with existing product designs, we are able to enhance the application in terms of:

## TECHnote



### Reliability

- Contacts feature individual wire-seals to ensure water-tightness to IPX9K
- Cover and mounting flange have seals for water tightness to IP54, adaption of corrugated tube
- Premium cover seal and unique central-load spring ensures water tightness (IPX4) when plug is not connected
- Plated contacts and active face seal prevent corrosive damage to contacts when plug is connected
- Flange seal is available to prevent water ingress between the socket and the vehicle or nose box
- Stainless steel mounting bolt bushings allow higher tightening torque



### Maintenance

- Modular design for easy repair or replacement
- Harness connector secured to socket housing with secondary locking feature
- 7-pin sockets and harness connector housings are labeled and color coded
  - Green = SAE J560 Primary
  - Yellow = SAE J560 Auxiliary
- Custom cover lettering available
- 90° or straight back-shell cover is easily removed and replaced for service and repair



### Lower Cost

- No preattached expensive jacketed cable
- No over-mold tooling, process, and materials
- Increased flexibility of harness supplier selection
- Production process for harness maker is commonized with all other vehicle component harnesses
- Contact crimping and insertion can be performed by any harness manufacturer
- Lower weight contributes to lower operating costs

### Highlights

- Exceeds all SAE requirements
- 100% Watertight WEATHERLOCK™ technology (IPX9K)
- Socket housing with reception of contact insert and securing bracket
- Contact insert with terminal position assurance (TPA)
- Socket housing using FIBERCORE™ with metal bushings
- Cable outlet as fold cover with latch (can only be closed if TPA is locked)
- Works best from -40°F to 185°F (-40°C to 85°C)
- 90° cable outlet for small installation spaces



SCAN to WATCH





by  ERICH JAEGER

## TECHnote

### 7P/12V 100% Waterproof WEATHERLOCK™ Connectors - SAE J560

Socket housing with seal on bottom of SAE J560 connection

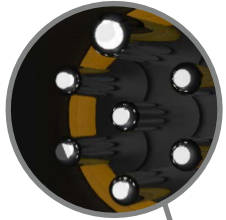

Socket housing with metal bushings



Separate contact housing with integrated circumference seal ensure highest water protection



Cable outlet as fold cover with latching hook and fixed securing bracket



Cable outlet for corrugated tube

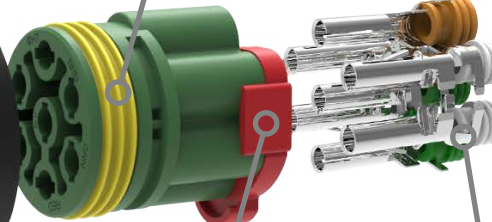

Socket housing with seal in cover



Socket housing with reception of contact insert and securing bracket

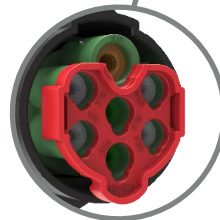

Contact insert with terminal position assurance (TPA)

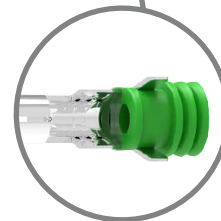

Crimp contacts with single wire seals ensure highest water protection



Available as 180° and 90° cable outlet (90° version for small installation spaces)



by ERICH JAEGER

# TECHnote

## Model Versions



Set

7P/12V EXPERT watertight socket - SAE J560 Primary

Set with nickel plated crimp contacts, contact insert, seal and cable outlet (180° and 90°) for corrugated tube NW17

Part No.  
101390



Set

7P/12V EXPERT watertight socket - SAE J560 Auxiliary

Set with nickel plated crimp contacts, contact insert, seal and cable outlet (180° and 90°) for corrugated tube NW17

101391

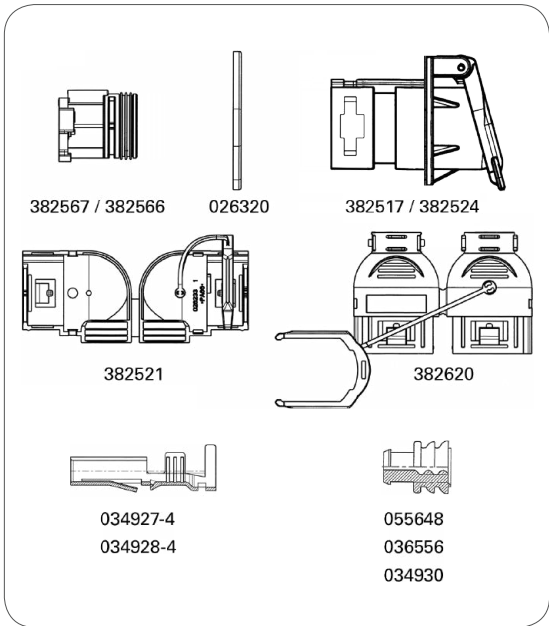

7P/12V EXPERT socket housing - SAE J560 Primary

382517

7P/12V EXPERT socket housing - SAE J560 Auxiliary

382524

Contact insert - Primary

382567

Contact insert - Auxiliary

382566

Cable outlet 180°, for corrugated tube NW17

382620

Cable outlet 90°, for corrugated tube NW17

382521

Seal

026230

Crimp contact socket

12-10 AWG  
8 AWG

034927-4  
034928-4

Single wire seal

12 AWG  
10 AWG  
8 AWG

055648  
036556  
034930





by  ERICH JAEGER

# TECHnote

## Model Versions



Hand crimping tool for crimp contacts and single wire seals (8, 10, 12 AWG)

Part No.  
361065

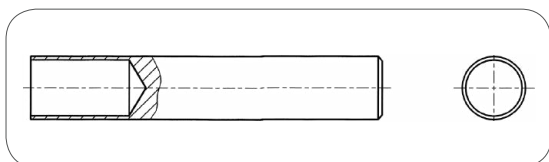

Contact ejector bush

026321



7P/12V EXPERTECH™ cable with DURACORE™ plugs- SAE J560 Primary green cable (4x 3.0mm<sup>2</sup> + 2x 5.0mm<sup>2</sup> + 1x 8.0mm<sup>2</sup>)

Cable length	Packaging
--------------	-----------

12,5ft	PE bag
12,5ft	no
13,0ft	PE bag
13,0ft	no
14,3ft	PE bag
14,3ft	no
18,0ft	PE bag
18,0ft	no

611264  
611243  
611263  
611259  
611262  
611244  
611261  
611231



7P/12V EXPERTECH™ coil with DURACORE™ plugs - SAE J560 Primary green cable (4x 3.0mm<sup>2</sup> + 2x 5.0mm<sup>2</sup> + 1x 8.0mm<sup>2</sup>), coil diameter: 100mm

Working length	Max. extension length	Packaging
----------------	-----------------------	-----------

3.5m / 12ft	4.5m / 14ft 9in	PE bag
3.5m / 12ft	4.5m / 14ft 9in	no
4.5m / 15ft	5.0m / 18ft	PE bag
4.5m / 15ft	5.0m / 18ft	no

611268  
611222  
611267  
611224



7P/12V EXPERTECH™ coil with DURACORE™ plugs - SAE J560 Auxiliary yellow cable (4x 3.0mm<sup>2</sup> + 2x 5.0mm<sup>2</sup> + 1x 8.0mm<sup>2</sup>), coil diameter: 100mm

Working length	Max. extension length	Packaging
----------------	-----------------------	-----------

3.5m / 12ft	4.5m / 14ft 9in	PE bag
3.5m / 12ft	4.5m / 14ft 9in	no
4.5m / 15ft	5.0m / 18ft	PE bag
4.5m / 15ft	5.0m / 18ft	no

611266  
611223  
611265  
611225